

SPECIFICATIONS

DEFINING THE CYLINDER WITH TIE-RODS CATALOGUE NUMBER

To order, please specify:

■ Cylinder description:

PES cylinder with tie rods and aluminium barrel
cylinder equipped for magnetic position detectors

■ Cylinder catalogue number and stroke indication (in mm):

Ø (mm)	PES equipped for detectors (2) cylinder with tie rods aluminium barrel
63	45051043 ... (1)
80	45051044 ... (1)
100	45051045 ... (1)
125	45051046 ... (1)

(1) Indicate the stroke (in mm), preferably choosing standard values (see standard equipment, page P229)

(2) **The magnetic position detectors are ordered separately:**

- "T" model (see page P291), reed switch or magneto-resistive type
- "BIM" model, magneto-inductive (see page P297)

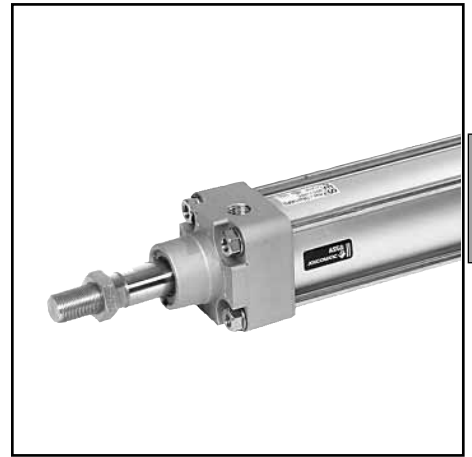

B

ACCESSORIES

- Female rod clevis and spherical rod end:

The following table shows all the clevises and self-aligning eyes that fit oversize rod ends with allowance for the rod end thread diameter difference.

Ø (mm)	catalogue number	
	female rod clevis ISO 8140	spherical rod end ISO 8139
63	43400019	43400004
80	43400020	43400005
100	43400020	43400005
125	43400021	43400006

DIMENSIONS (mm)

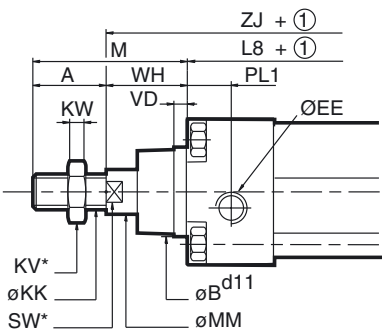

Cylinder with profiled barrel
Ø 63 to 125 mm
Cylinder with tie rods
Ø 63 to 125 mm

Ø (mm)	A	ØB	ØEE	ØKK	KV	KW	L8	M	ØMM	PL1	SW	VD	WH	ZJ
63	40	45	G3/8	M20x1,5	30	10	121	86	25	26	22	6	46	167
80	54	45	G3/8	M27x2	41	13,5	128	119	30	24	27	6	65	193
100	54	55	G1/2	M27x2	41	13,5	138	119	32	25	27	6	65	203
125	72	60	G1/2	M36x2	55	18	160	152	40	32	36	10	80	240

① Stroke
* Size across flats

Female rod clevis AP2-ISO 8140

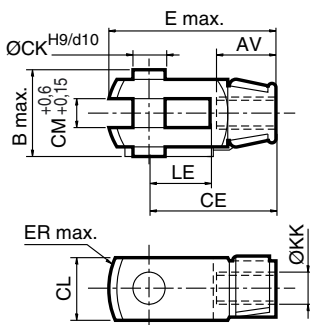

Spherical rod end AP6-ISO 8139

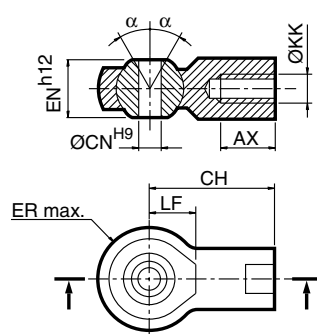

Ø (mm)	AV	AX	B	CE	CH	ØCK	CL	CM
63	33	33	48	80	40	20	40	20
80	51	51	65	110	110	30	55	30
100	51	51	65	110	110	30	55	30
125	56	56	84	144	125	35	70	35

Ø (mm)	ØCN	E	EN	ER	ØKK	LE	LF	α
63	20	112	25	25	M20x1,5	40	26	4°
80	30	155	37	35	M27x2	54	36	4°
100	30	155	37	35	M27x2	54	36	4°
125	35	201	43	40	M36x2	72	41	4°