



OVERALL SPECIFICATION

FLUID : Compressed air or neutral gas
The compressed air used must be dry to prevent ice buildup

PORTS : G3/4 to G1 1/2

MAX. INLET PRESSURE at 23°C : 17,5 bar
at 50°C : 12 bar

AMBIENT TEMPERATURE : -10°C to +50°C (+ 60°C at 12 bar)

MAX. FLOW (P1=10 bar) : G3/4 = 10400 l/mn - G1 = 11400 l/mn

BOWL CAPACITY total : 500 cm³
useful : 300 cm³



CONSTRUCTION

Filtering capacity 30 µm or 5 µm
Filtering element of sintered plastic
Aluminium body
Metal bowl with polypropylene level viewing window
Bowl equipped with pipable semi-automatic or automatic drain
(operating pressure: 2 to **12 bar**) or manual drain as option

CHOICE OF EQUIPMENT

port size	maximum flow (ANR) inlet pressure 8 bar		code						
			manual drain (4)		semi-automatic drain		automatic drain		
			30 µm	5 µm (1)	30 µm	5 µm (1)	30 µm	5 µm (1)	
	(l/min)	(dm ³ /s)							
Standard filter									
G 3/4	9700	162	34207005	34207017	34207001	34207013	34207009	34207021	
G 1	10300	172	34207006	34207018	34207002	34207014	34207010	34207022	
G 1 1/4 ⁽³⁾	10300	172	34207007	34207019	34207003	34207015	34207011	34207023	
G 1 1/2 ⁽³⁾	10300	172	34207008	34207020	34207004	34207016	34207012	34207024	
Filter designed to receive a pressure switch (2)									
G 3/4	9700	162	34207041	34207053	34207037	34207049	34207045	34207057	
G 1	10300	172	34207042	34207054	34207038	34207050	34207046	34207058	
G 1 1/4 ⁽³⁾	10300	172	34207043	34207055	34207039	34207051	34207047	34207059	
G 1 1/2 ⁽³⁾	10300	172	34207044	34207056	34207040	34207052	34207048	34207060	

- (1) With a filtering element of 5 µm, the flow is reduced by approx. 15 %
- (2) Use the hexagon adapter to install the subbase-mount pressure switch (see accessories)
- (3) The G 1 1/4 and G 1 1/2 versions are composed of a G 1 version + 1 set of 2 G 1 1/4 or G 1 1/2 flanges (1 connecting flange for each end of each component). When assembling several components together (FRL, isolation valve etc...), select G 1 components and provide for 1 set of G 1 1/4 or G 1 1/2 flanges (see pages 21 and 22 for flanges assembly)
- (4) Metal manual drain

OTHER PRODUCT OPTIONS

- Hexagon adapter for the installation of a subbase-mount pressure switch at front (see accessories)
- Subbase-mount (see P718-1) or electronic (see P718-2) pressure switch
- By-pass module (see page 16)

ACCESSORIES (see pages 21 - 22)

PRESSURE LOSS VERSUS AIR FLOW CURVES

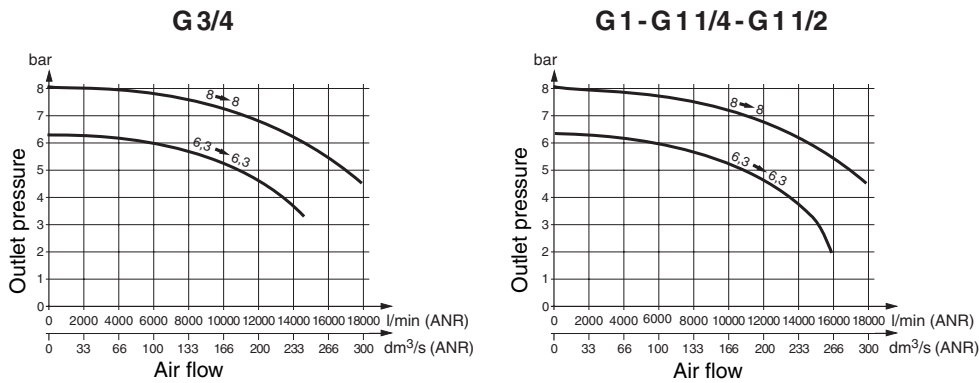

DIMENSIONS AND WEIGHTS - G3/4 - G1 VERSIONS

Weight: 0,900 kg

Mounting with side brackets

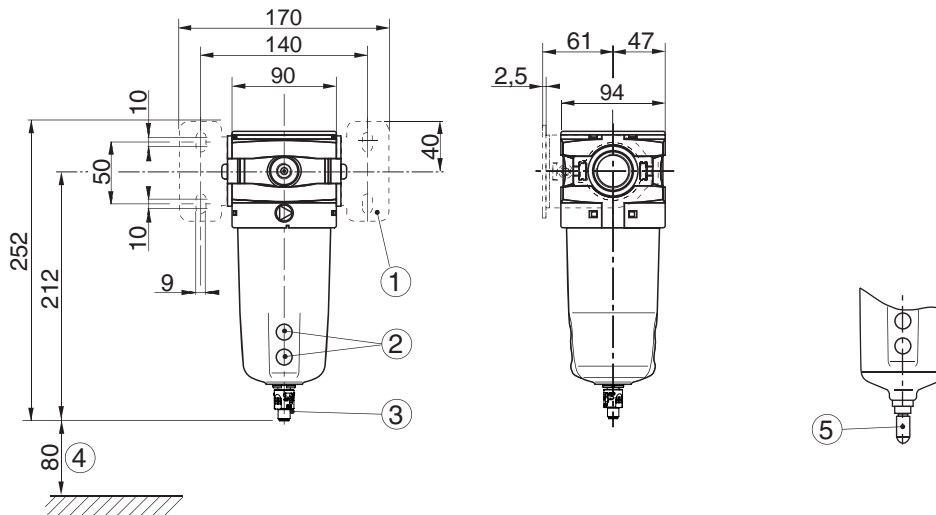

G 1 1/4 - G 1 1/2 versions - see accessories

- ① Mounting with 2 side brackets (accessory)
- ② Condensate level window
- ③ semi-automatic drain connectable G1/8
- ④ Clearance required for bowl removal
- ⑤ Automatic drain connectable to 6 mm ID flexible tubing

INSTALLATION AND MAINTENANCE

Products must be installed with the bowls in vertical position (at the bottom).

Air flow direction indicated by arrow (►)

Use an alkaline solution (soapy water) and not a solvent for cleaning the polycarbonate bowls and sight glasses.